

SIMPLE DECOUPAGE COLLAGE ART

LEARN THE ART OF LAYERING
WITH PAINT & PAPER



For over fifty years, Mod Podge has been America's favorite all-in-one glue, sealer and finish. Today, it is used by creators, makers, general crafters, and DIY enthusiasts in decoupage, mixed media, and multiple general crafting techniques.

The art form of decoupage is simply cutting and pasting paper or fabric either in a single layer or collaged in multiple layers onto a wide variety of surfaces such as wood, metal, canvas, terra cotta, papier mache, and fabric. With 23 unique Mod Podge formulas, there is always a formula suited for your crafting needs, whether decorating for your home, working with the kids, upcycling, or creating mixed media collage works of art.

The projects in this book, Mod Podge Collage Art, are all created from wonderfully designed patterned papers which can be easily downloaded and printed from your home computer. With each distinctly different project, you will also find a pattern or template, a complete list of supplies and easy-to-comprehend written instructions, as well as a few step-by-step photos, to guide you through the process of creating Mod Podge Collage Art!

Experiment and have fun with a variety of Mod Podge formulas, the FREE downloadable paper designs, and a wide range of color using FolkArt Acrylic Paints creating decoupage collage art to accessorize your home or give to friends as gifts!

TABLE OF CONTENTS

HISTORY OF MOD PODGE	3
BASICS OF MOD PODGE SURFACE PREP.....	4
MISCELLANEOUS SUPPLY LIST.....	4
BASICS OF DECOUPAGING WITH MOD PODGE.....	5-6
PAPER PRINTING & PREPARATION INSTRUCTIONS.....	7
BOHEMIAN FEATHERS	8-9
Template	10
Patterned Papers	11-14
BRIGHT & CHEERFUL FLORAL STILL LIFE.....	15-16
Template	17-19
Patterned Papers	20-24
TROPICAL LEAVES.....	25
Template	26
Patterned Papers	27-30
MOD PODGE FORMULA GUIDE CHART	31
MOD PODGE SOCIAL MEDIA / CREDITS.....	32



HISTORY OF MOD PODGE

What is Mod Podge? Mod Podge is a craft medium that was created in 1967 to meet the demands of the ever-popular crafting trend - decoupage.

What is decoupage? Decoupage: a French word, meaning to cut out, is referred to as the art of cutting out paper images, adhering them to a surface and then brushing over with multiple layers of varnish or lacquer. Fifty plus years ago, this was a tedious, time-consuming, and messy craft, as each layer of solvent-based varnish, needed proper ventilation and dry time. Decoupage artists would also sand between layers to keep the surface even and smooth.

In 1967, to “modernize” labor-intensive decoupage techniques, Jan Wetstone, an Atlanta native, created the first water-based decoupage medium, and Mod Podge was born! As a water-based product, it could be used as a glue, a sealer and a varnish, making it perfect for modern day decoupage techniques. Using water-based Mod Podge in place of solvent-based varnishes sped up the dry times and the decoupage process allowing artisans the ability to create more pieces in less time! The first two Mod Podge formulas developed were Gloss and Matte. Mod Podge, itself, is short for “modern decoupage.”

Plaid Enterprises purchased Mod Podge in 1979 and the rest is history! Since the initial purchase of Gloss and Matte, Plaid has also developed the product line to many exciting, easy-to-use formulas, a variety of applicators and tools as well as several creative accessory products.

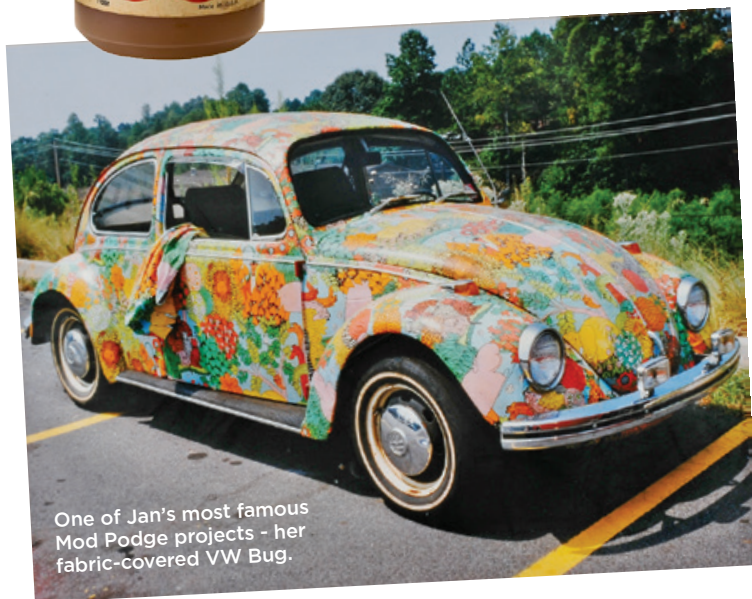
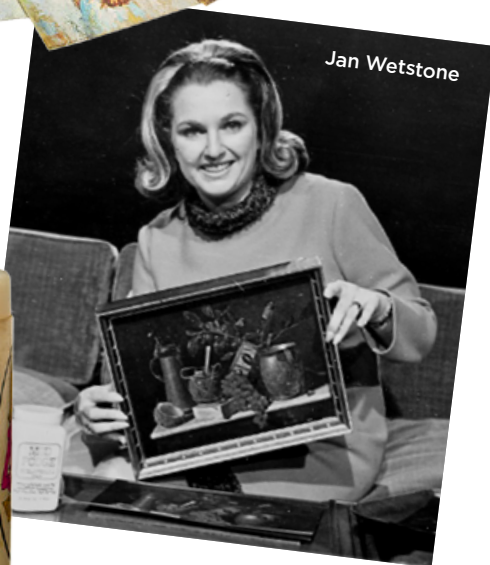

BASICS OF DECOUPAGING WITH MOD PODGE

Taking the mystery out of decoupage is easy when creating with Mod Podge products. And although there are many different formulas offering different sheens that can be used on a variety of surfaces, the basics of “Mod Podging” is the same. Let’s take a look at just how easy it is to Mod Podge a surface.

- A** Gather all necessary supplies.
 - B** Begin by preparing the scrapbook paper to fit the project surface. Either measure with a ruler and mark the shape using a pencil on the desired scrapbook paper, or press along the edges of the surface creating a crease in the paper.
 - C** Carefully trim the patterned paper, using Mod Podge scissors, to the desired shape. If using paper appliques, carefully trim around the applique design.
 - D** Using a color of acrylic paint that coordinates with the paper design, and a Mod Podge foam applicator apply a smooth, even basecoat to the project surface. Allow to dry.
 - E** Apply an even coat of Mod Podge, formula of choice, onto both the backside of the pre-cut paper as well as the front side of the project surface using a Mod Podge gold Taklon bristle brush.
- TIP:** Mod Podge Foam Applicator can also be used, however, fewer brush marks will be created when using light pressure and a Taklon bristle brush.

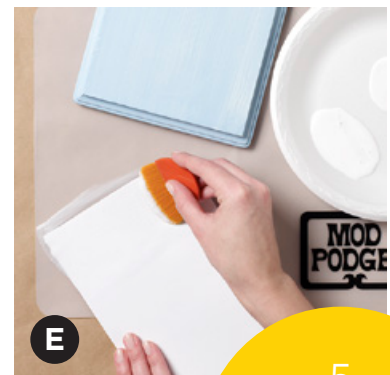
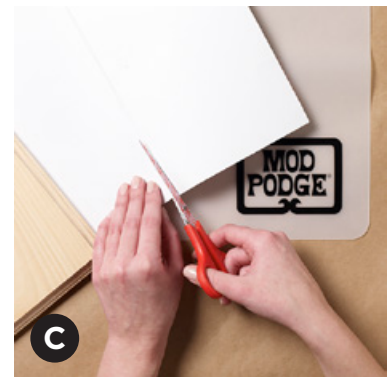
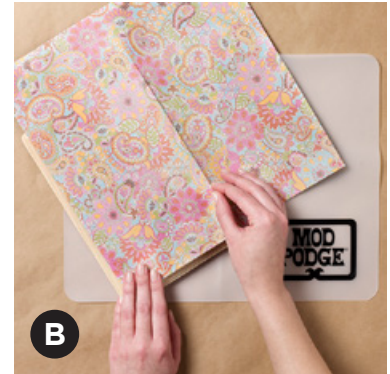
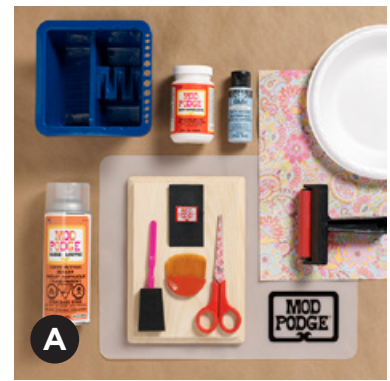

BASICS OF DECOUPAGING WITH MOD PODGE

- F** Carefully, flip the decoupage paper over and position it onto the project surface matching the edges.

TIP: It is best to position “glue to glue” when decoupage as this will ensure the stability of the paper to the surface. It may also provide a moment or two to move the paper into the correct space before it takes hold.

- G** Smooth paper in place using clean hands, a Mod Podge Squeegee or a Mod Podge Brayer. Allow to dry 15–20 minutes.

TIP: When smoothing the paper on the project surface, smooth from the center outwards. If excess Mod Podge is squeezed out, quickly wipe to remove the excess using a damp paper towel.

TIP: Many crafters also find it easier to work with a sheet of clean waxed paper between the decoupage paper and the smoothing tool. The squeegee or brayer will easily glide over the waxed paper making it easier to smooth into place. It may also capture the excess Mod Podge squeezed onto the image edges. Carefully lift to remove the wax paper while still wet. Allow decoupage image 15–20 minutes to dry.

- H** After 20 minutes, brush on a topcoat of desired Mod Podge formula to seal and protect the decoupage design. Allow to dry.

TIP: Dry times may vary depending on the thickness of the Mod Podge applications, humidity and air flow. Be patient and allow the decoupage area to thoroughly dry before applying additional topcoats.

- I** Once the decoupage surface is dried and cured, if stickiness remains due to humidity, lightly spray seal the Mod Podged surface using a Mod Podge Spray Clear Acrylic Sealer (formula of choice.)

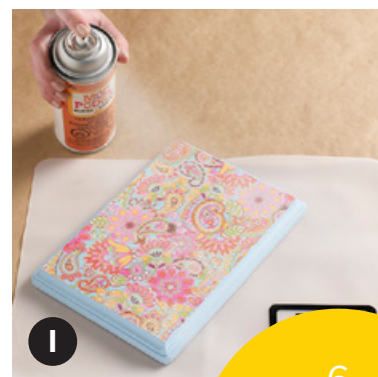
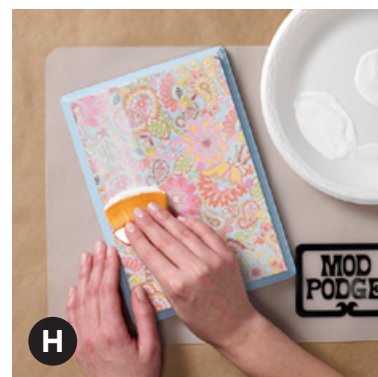
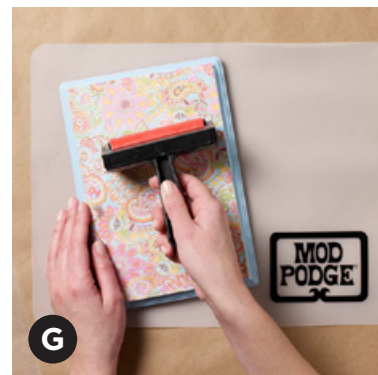

PAPER PRINTING & PREPARATION INSTRUCTIONS

All of the projects in this Mod Podge Collage Art eBook were specifically designed as FREE downloadable patterned art.

Each project may use four to five different patterned designs to complete a project. All patterned designs can be printed on 8½" x 11" sheets of paper.

Each project also includes a pattern specific for that project. These template patterns can be printed on 8½" x 11" paper too, making it easy to recreate each project to the same scale and exact size as the original.

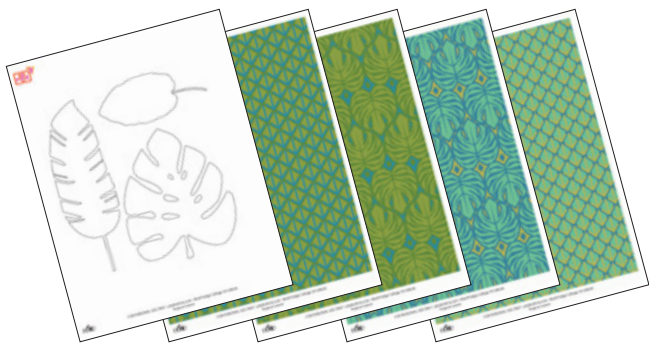

HOW TO PRINT THE PATTERNED PAPERS & TEMPLATES

All of the patterned papers, as well as the template pattern for each project, can be printed directly from this book. Simply select the desired project, turn to the template and patterned art pages, then select “print”, indicating the corresponding page numbers. For example: when printing papers for the Tropical Leaves project, print one set of papers requesting pages 26 through 30.

HOW TO DOWNLOAD THE PATTERNED PAPERS & TEMPLATES

These same patterned art papers and template patterns are also available in a pdf format that can be downloaded free from plaidonline.com. Simply follow the link indicated in each supply list, then print out the desired amount of papers.

HOW TO PREPARE THE PAPER

It is best to print all of the necessary papers on a dry toner or laser printer to complete each project.

IMPORTANT: If printing on an inkjet printer, the printed papers should be sealed before working with Mod Podge. Inkjet printers produce prints created from water-based inks and may be susceptible to damage when working with water-based Mod Podge. Inks on the printed images may “re-wet” causing colors to blur slightly. To prevent this from happening with an ink jet printed paper, lightly spray seal the printed image with a couple light coats of Mod Podge Matte Clear Acrylic Spray before cutting.

NOTE: When printing from a laser printer, it is not necessary to spray seal the printed paper prior to working with Mod Podge.

Helpful Hints

- A couple projects in this eBook suggest that the printed patterned paper is reinserted into the printer to then print the template pattern on the backside of the design. Be sure to follow your personal printer’s instructions for page direction making sure the template is printed following the natural direction of the printed patterned paper. It may require a “test” print to make sure the template pattern is printed right side up.
- Once all the patterned paper designs are printed, trim the excess white border on each page using either scissors or a craft knife and ruler.
- As indicated above, if the patterned paper is printed from an inkjet printer, be sure to spray seal the printed side with a couple light applications of Mod Podge Matte Clear Acrylic Spray Sealer to set the ink.

BOHEMIAN FEATHERS

Paper Designer: Kati Sellers
Project Creator: Suzanne Cook

Following the carefree, bohemian trend this Mod Podge Collage Art project incorporates the use of paper beads that you can easily create. These same paper beads can effortlessly be transformed into a jewelry statement you would be proud to wear!

INSTRUCTIONS

Follow the Paper Printing and Preparation Instructions found on page 7. Also review the Basics of Decouping with Mod Podge found on pages 5-6.

Canvas

1. Prepare canvas using the FolkArt Basecoating brush, with two coats of FolkArt Red Violet. **NOTE:** Be sure to allow the first coat to thoroughly dry before applying the second coat. Allow to dry.



2. Using scissors, carefully cut out the feather pattern. Also cut out the cone and barrel bead patterns.
3. Position the feather pattern on the backside of a selected patterned paper; trace around the feather shape using a pencil then cut it out. Repeat this step until four different patterned paper feathers are created. For design placement, lay the feathers on the face of the canvas in the desired order.
4. Working one paper feather at a time, lay the feather pattern side down on the Mod Podge Silicone Mat. Apply Mod Podge Gloss to both the backside of the feather and the front side of the painted canvas. Flip the paper feather over then position on the canvas where desired, press in place. Using either the Mod Podge Squeegee or the Mod Podge Brayer, smooth the paper to the canvas removing air pockets, wrinkles and excess Mod Podge. Allow to dry approximately 20 minutes.
5. Brush a topcoat of Mod Podge Gloss over the entire canvas and allow to dry.

(Continued on next page)

Supply List

Mod Podge Gloss

[Mod Podge FREE Downloadable Papers - BoHo Feathers Collection](#) (5 different prints and 1 template page) - copy 2 sets of all papers

Mod Podge Seven-Piece Tool Kit

FolkArt Acrylic Colors - Red Violet

FolkArt Basecoating Brush Set

8" x 8" Stretched Canvas

Miscellaneous Supplies: Refer to page 4, plus a couple 1/8" diameter wood dowels, jute string (approximately 50" long)

BOHEMIAN FEATHERS

Paper Designer: Kati Sellers
Project Creator: Suzanne Cook

Paper Beads

1. To create the paper beads, trace both the cone and barrel bead pattern onto the backside of each desired patterned paper using a pencil. Trace patterns for as many beads as desired then cut each traced pattern out.

(Photo A) NOTE: The sample shown requires 20 paper beads.

2. Working one bead at a time, lay the patterned paper face down on the Mod Podge Silicone Mat. Place a thin dowel at the widest end of the paper. **(Photo B)** Roll the paper around the dowel one complete turn. Next, apply a small amount of Mod Podge Gloss onto the backside of the remaining paper, then continue rolling **(Photo C) NOTE:** It is best to periodically add a bit more Mod Podge while rolling up the bead. At the tail end of the paper, apply Mod Podge to secure the bead and let dry. Topcoat the entire bead with Mod Podge Gloss. Let dry, then slide the paper bead off the dowel.

Finishing

1. Cut a length of jute to go around the canvas, plus six inches = 38 inches. Tie knots approximately every two inches.

2. Using Mod Podge Gloss at the canvas corners, attach the knotted jute around the canvas. Let dry.

3. String a section of jute with the completed paper beads being sure to knot the jute before and after each bead. This will secure the beads in place. String four strands of jute with three beads and four strands of two beads.

4. Pair two strands of beaded jute (one / three-bead strand and one / two-bead strand) together. Next, tie a pair of beaded strands to the jute trim underneath each decoupage feather.

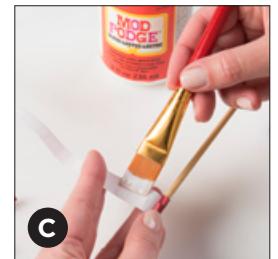
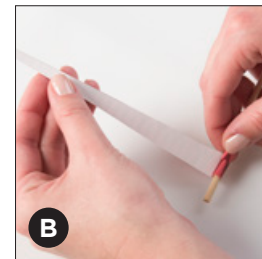
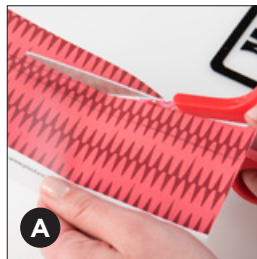

TIPS

- Experiment creating both the feathers and beads using the patterned paper both vertically and horizontally.
- Changing up the FolkArt Acrylic background color will create a huge difference in the finished project as well. Have fun trying a variety of coordinating colors! Switch out the jute, use another natural fiber or colorful ribbon.

cone .75 in
bead

barrell .5 in
bead

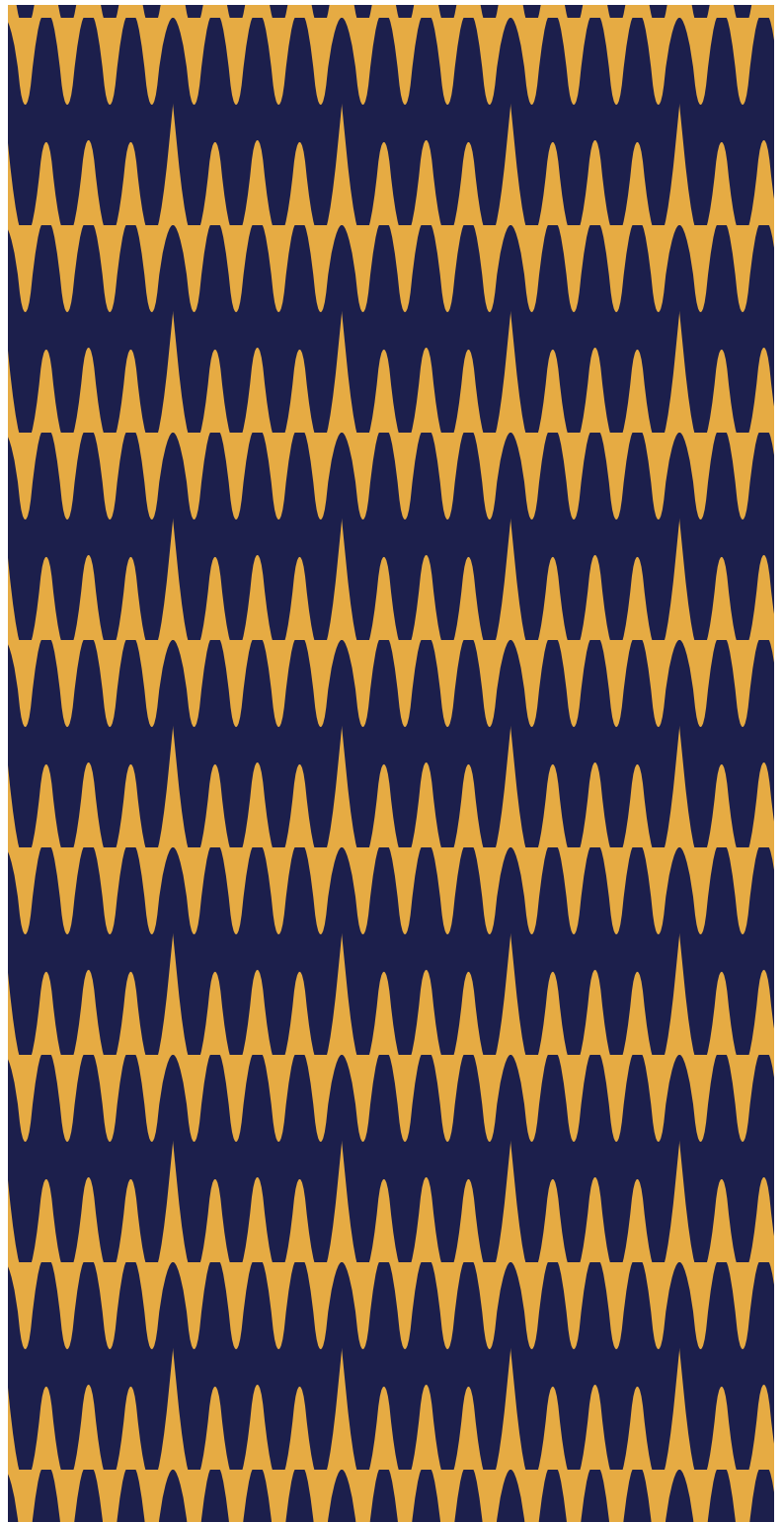
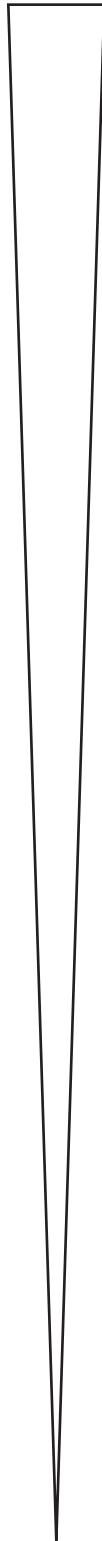
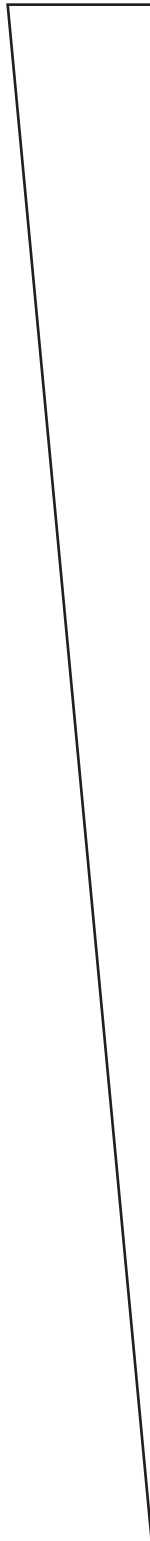
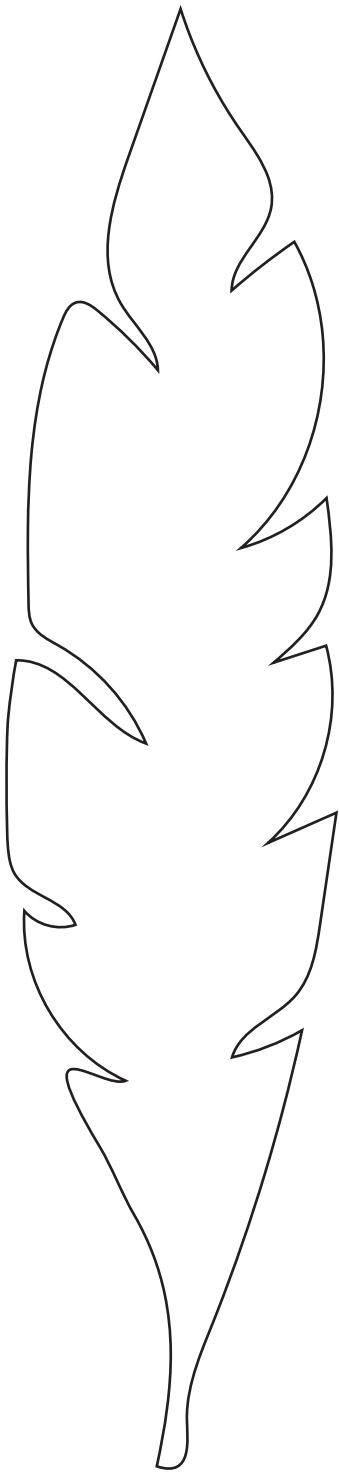

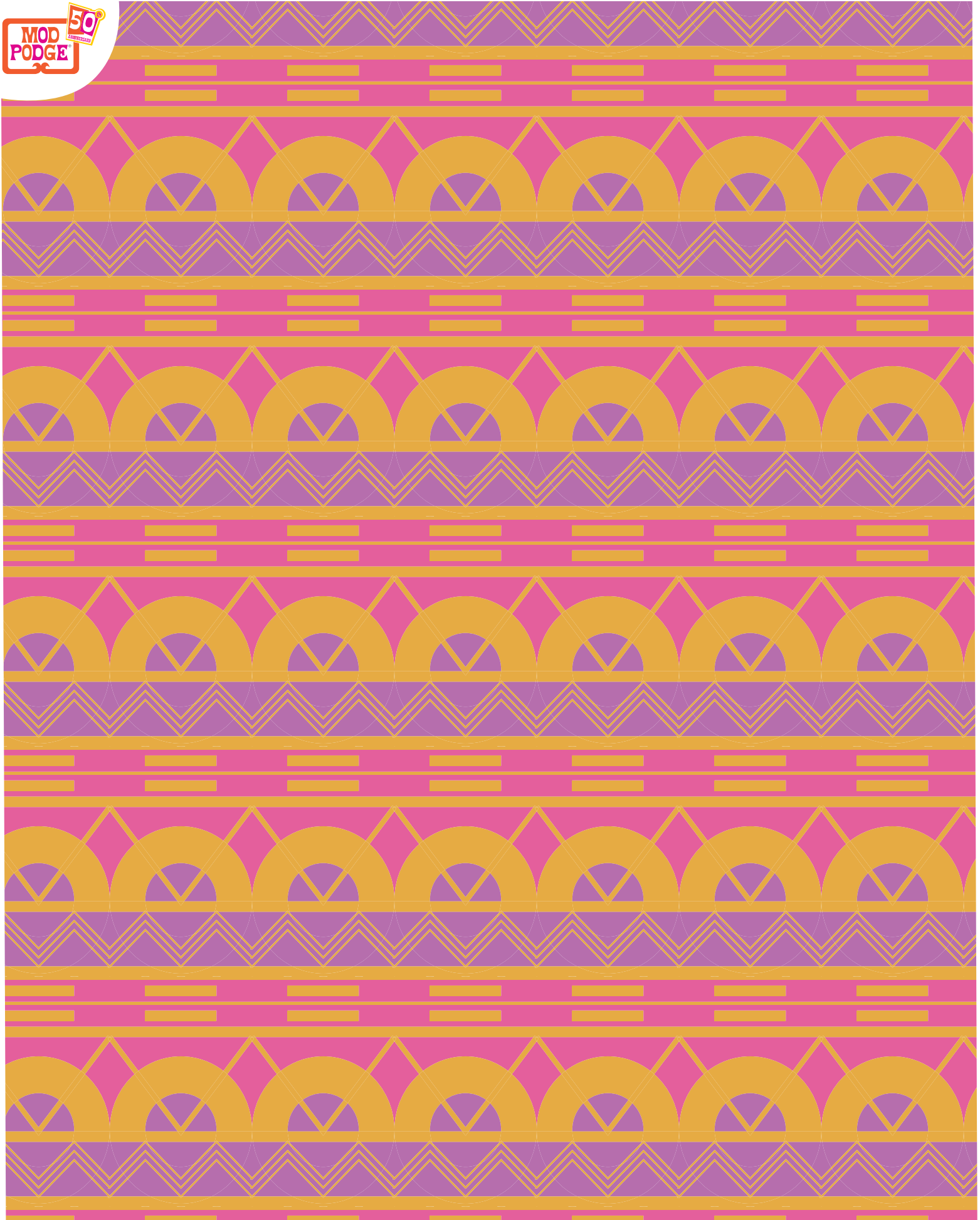

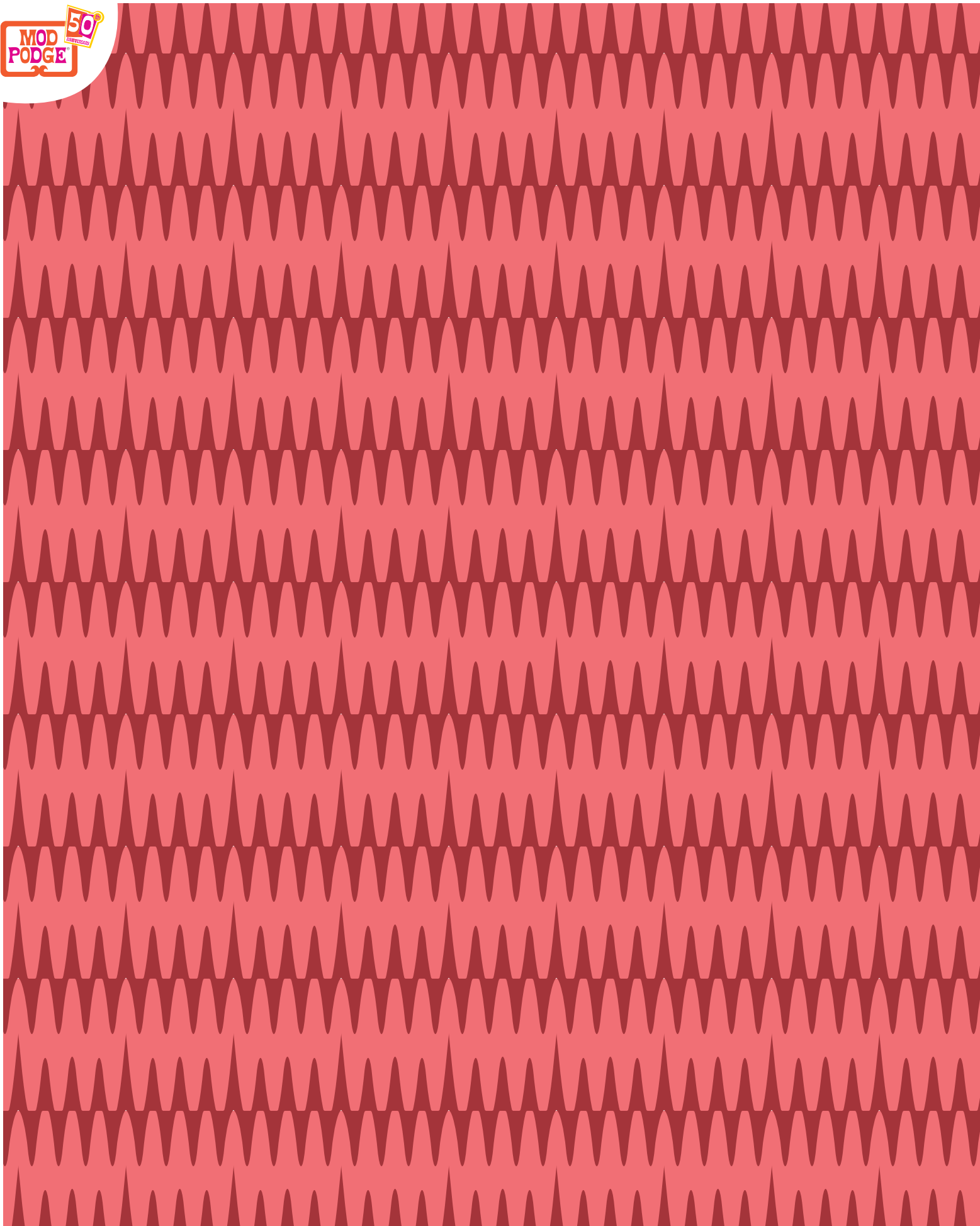



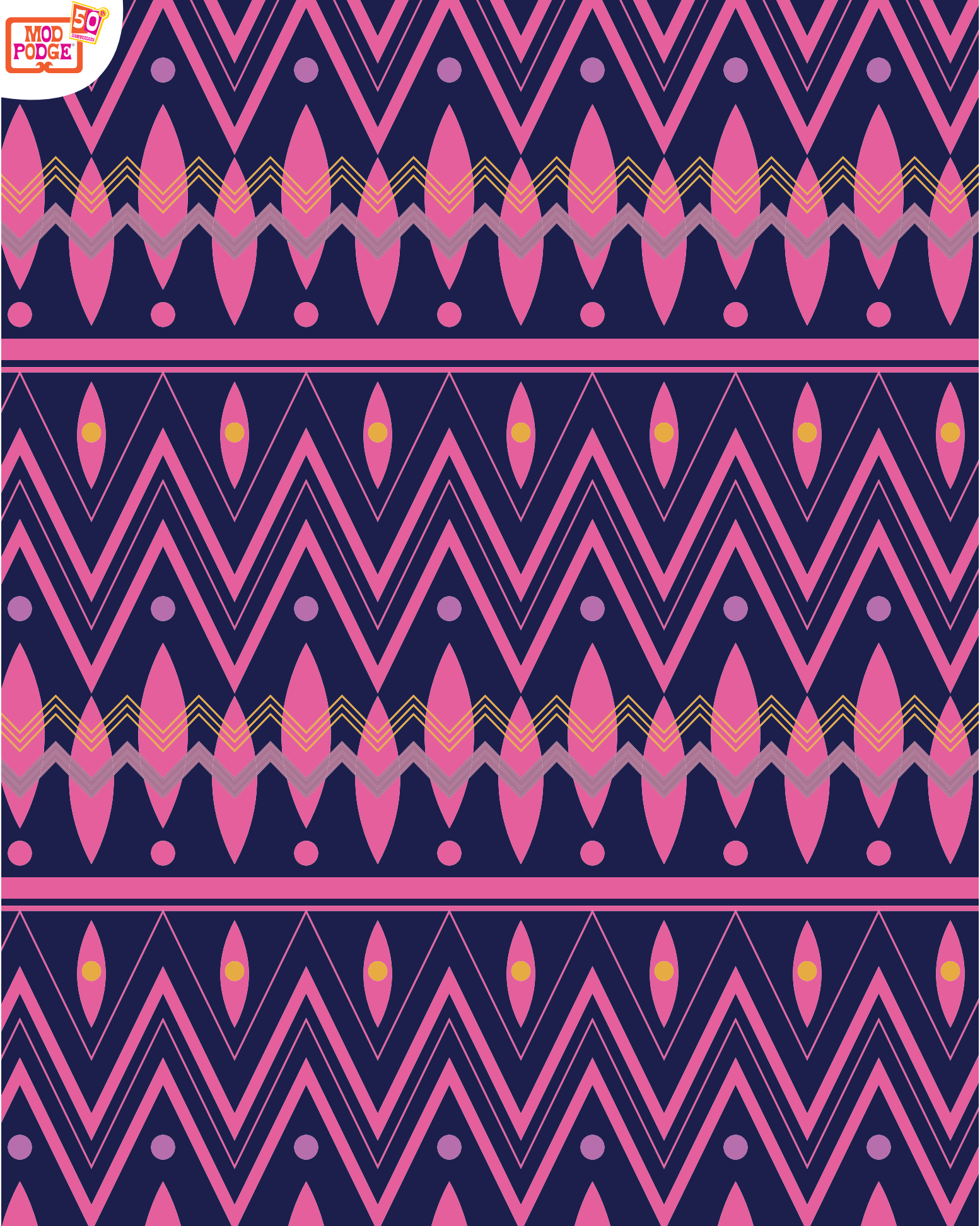

BRIGHT & CHEERFUL FLORAL STILL LIFE

Paper Designer: Kati Sellers
Project Creator: Suzanne Cook

This bright and cheerful floral still life is not only fun to create, it also is a lesson on color balance and placement. With five different papers to choose from, there are multiple color options! The leaves, as an example, are not all required to be green, try pink, red or blue patterned papers. Have fun with color choices and placement when creating this imaginative floral still life!

INSTRUCTIONS

Follow the Paper Printing and Preparation Instructions found on page 7. Also review the Basics of Decouping with Mod Podge found on pages 5-6.



Supply List

Mod Podge Ultra Matte Chalk

[Mod Podge FREE Downloadable Papers - Bright and Cheerful Floral Still Life Collection](#) (5 different prints and 3 template pages) - copy 4 sets of patterned papers and 1 set of template pages.

Mod Podge Seven-Piece Tool Kit

FolkArt Acrylic Colors - Ballet Pink

FolkArt Basecoating Brush Set

12" x 12" Gallery Wrapped Stretched Canvas

Miscellaneous Supplies: Refer to page 4, plus a 12" x 12" piece of paper

Canvas Prep

Using a FolkArt Basecoating Brush, apply a smooth, even application of Ballet Pink to the entire surface of the canvas. Allow to dry, then reapply a second coat. Let dry.



Creating the Still Life Composition

1. Begin by printing four copies of the patterned papers.
2. Reinsert one each of all five of the patterned papers back into the printer, then print the leaf and butterfly template onto the backside of each patterned paper. Repeat this step for the bird and flower template page as well as the leaf and flower pot template page, printing the template page onto the backside of each patterned paper. This will allow you several color and pattern choices when designing your colorful still life.

(Continued on next page)

BRIGHT & CHEERFUL FLORAL STILL LIFE

Paper Designer: Kati Sellers
Project Creator: Suzanne Cook

3. Cut out the desired shapes following the template printed on the backside of each patterned paper. Next, build the desired floral still life composition. Lay each cut shape onto a 12" x 12" sheet of paper as a placeholder. Continue cutting a variety of patterned shapes until the desired still life composition is achieved. **NOTE:** It is best to keep all the cut patterned pieces on the 12" x 12" sheet of paper until all pieces are decouped.

Decouping

1. Use the Mod Podge 3/4" flat brush included in the Tool Kit to apply Mod Podge Ultra Matte Chalk to the base of the canvas. Position two patterned table pieces print side down onto the Mod Podge Silicone Mat. Also brush a smooth, even coat of Ultra Matte Chalk to the backside of each "table" pattern piece. Flip the table pieces over and place onto the base of the canvas. **NOTE:** Use a Mod Podge Brayer or Squeegee to smooth the paper in place, release air pockets and remove excess Mod Podge.

2. Using the same decoupage techniques, attach the lower 2" of the flowerpot base onto the table. **(Photo A)** **NOTE:** Keeping the flowerpot top unattached at this time will allow you freedom to "build" the floral composition while placing leaf and/or flower stems "inside" the flowerpot.

3. Continue decouping one section at a time by adding leaves and flowers. Secure the top of the flowerpot over each leaf and flower stem. Continue collaging, add accents of butterflies and even decoupage a bird where desired. Allow to dry 20 minutes after the last section has been added.

Finishing

When dry, apply a final topcoat of Mod Podge Ultra Matte over the entire canvas including the sides. **(Photo B)** Allow to dry.

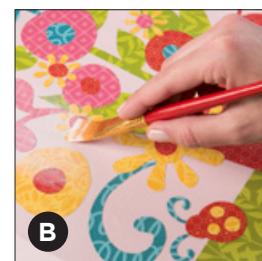
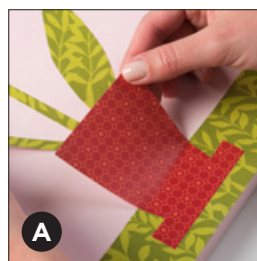

TIPS

- Although this project is gorgeous completed as a bright and colorful design, try completing it as a tone-on-tone or monochromatic design. As an example, use only the pink and red patterned papers.
- Try accenting some of the decouped areas such as flower centers, the dots on the lady bug, or even the bird's wings with Mod Podge Dimensional Magic for an epoxy-like dimensional clear accent.

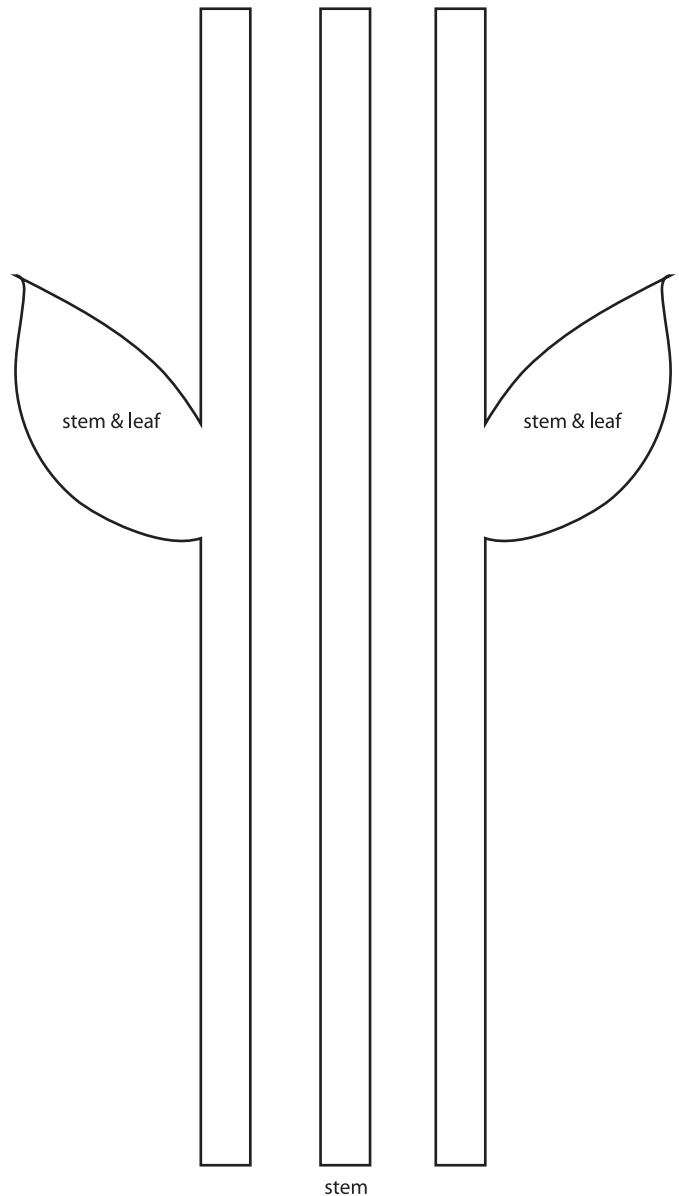
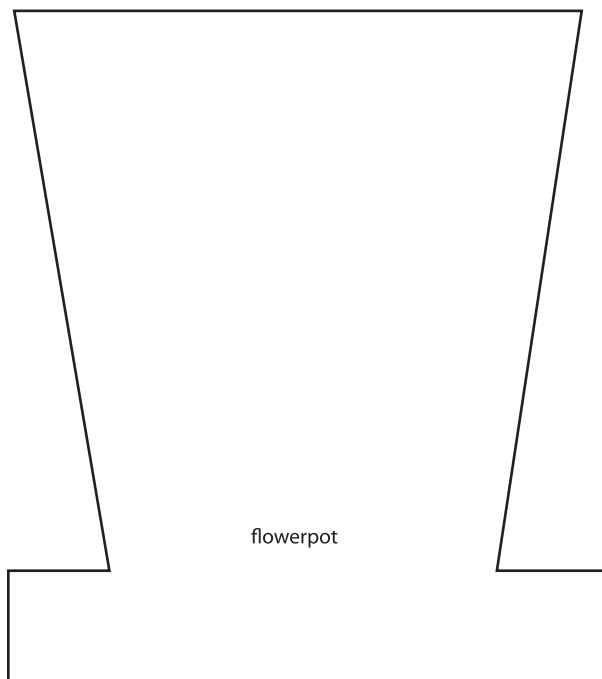
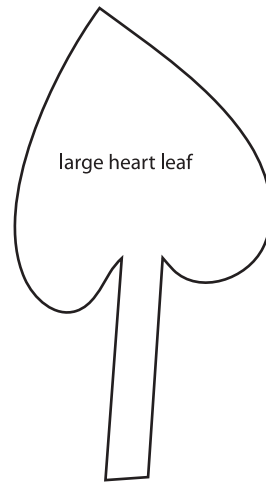
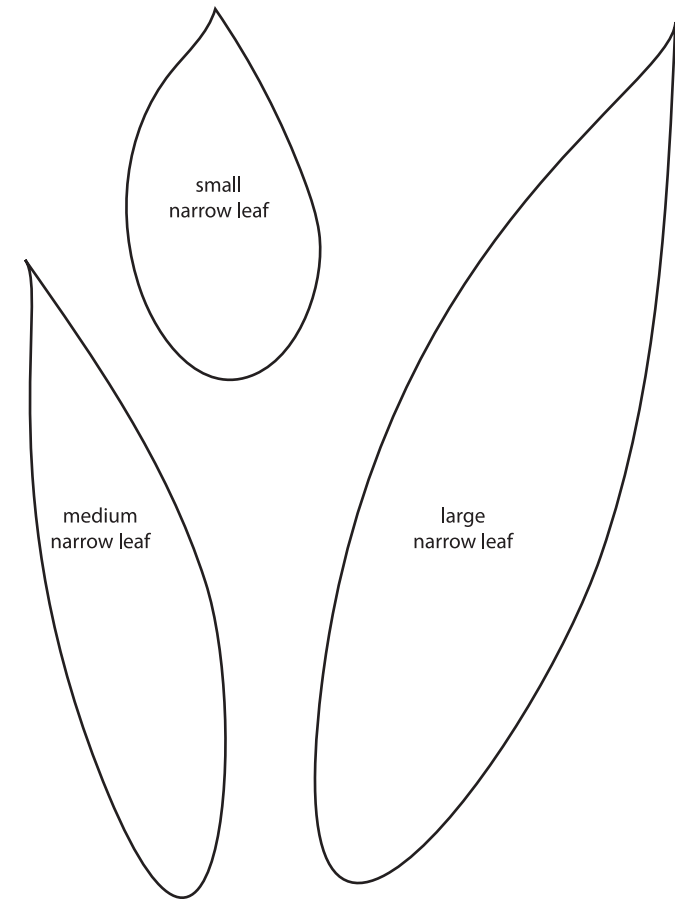

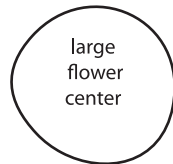
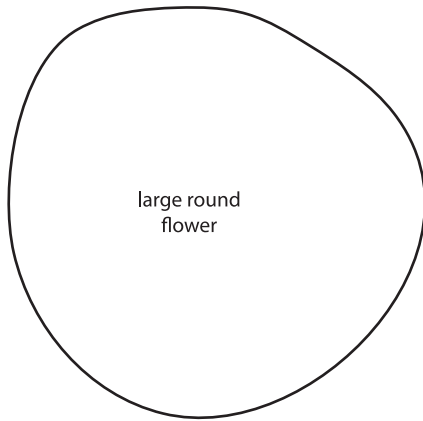
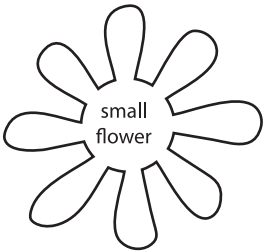
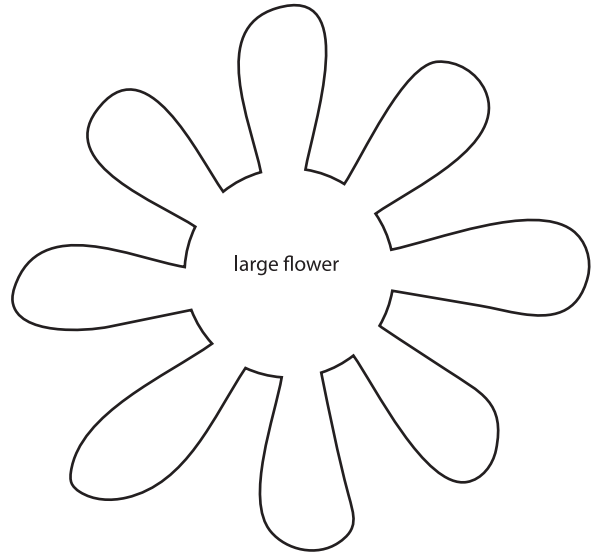
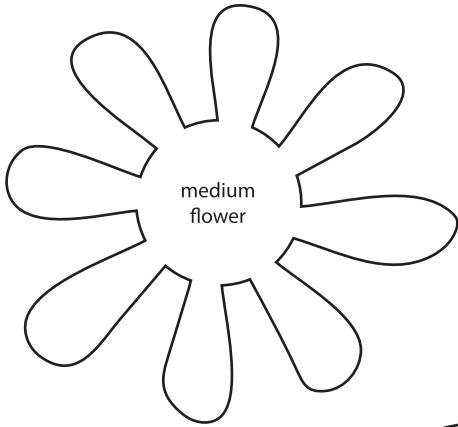

lady bug antennae

lady bug dots

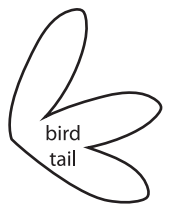
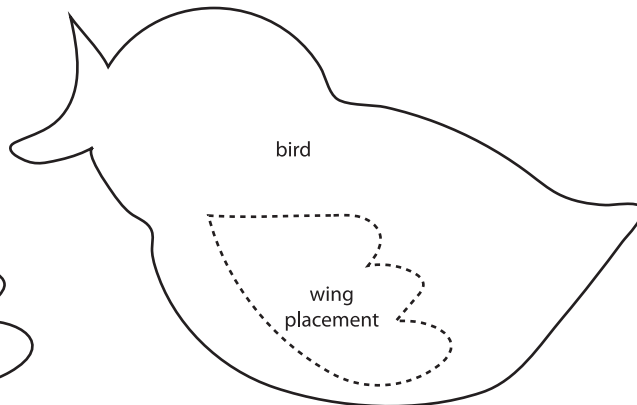
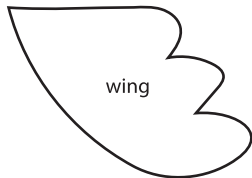
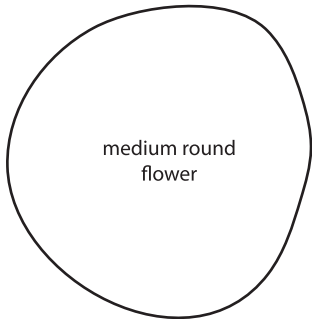
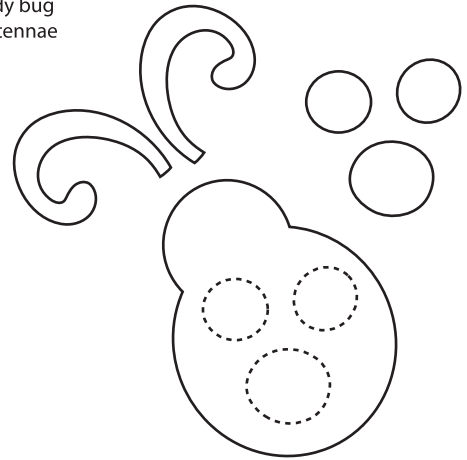

small antennae

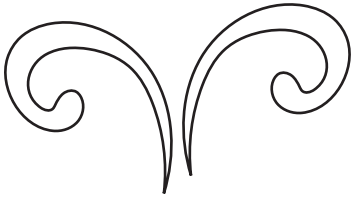

large antennae

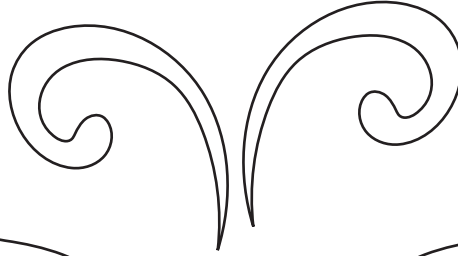

small butterfly

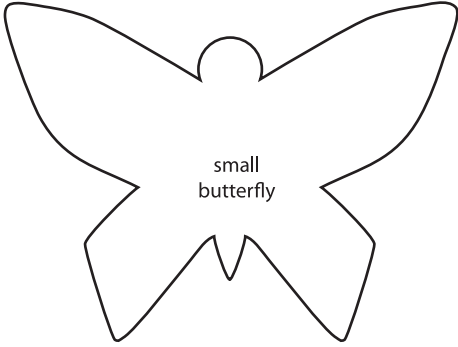

large butterfly

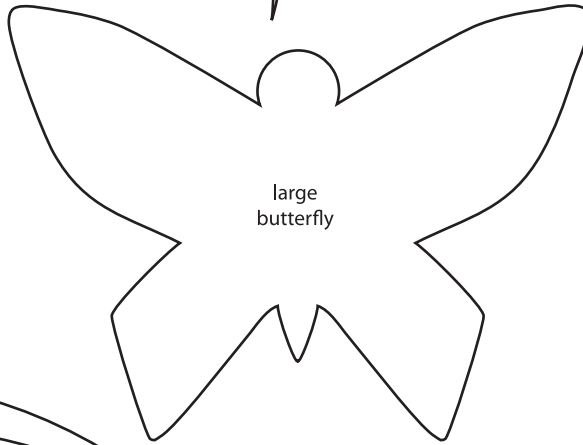
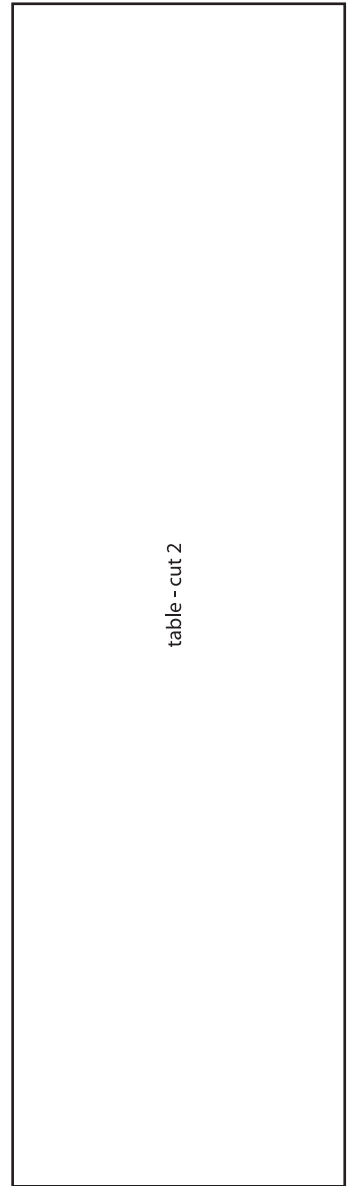
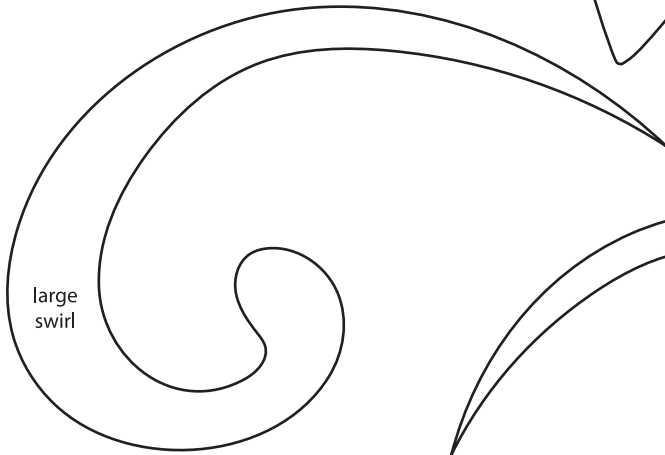

table - cut 2



large swirl



med swirl

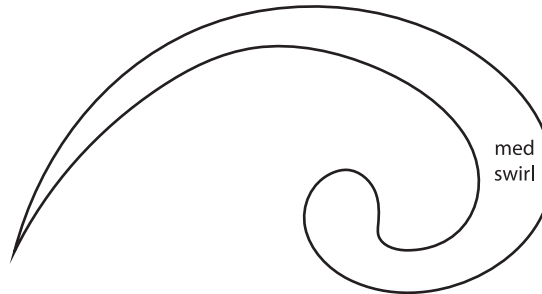

large fern

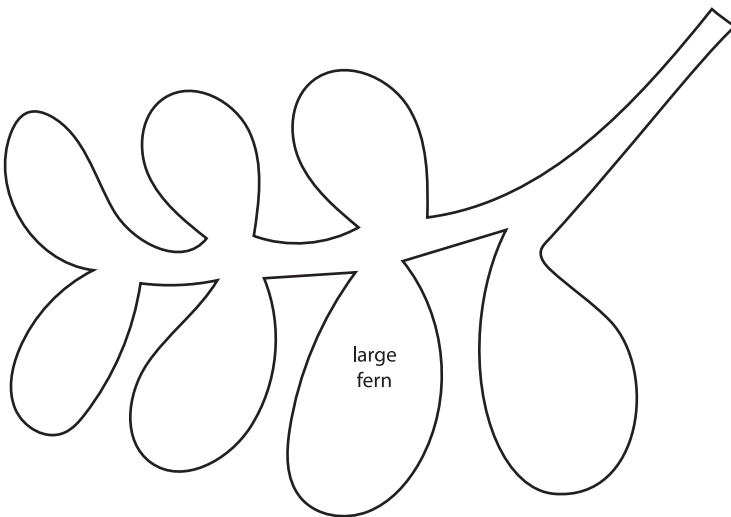

small fern

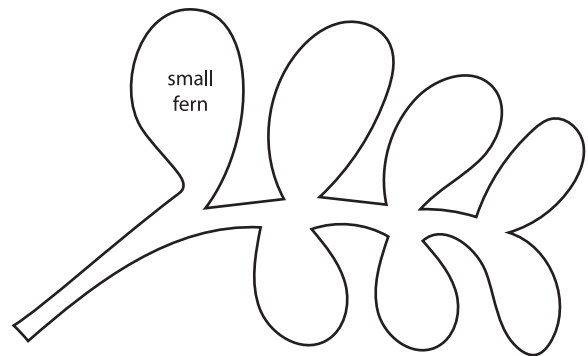





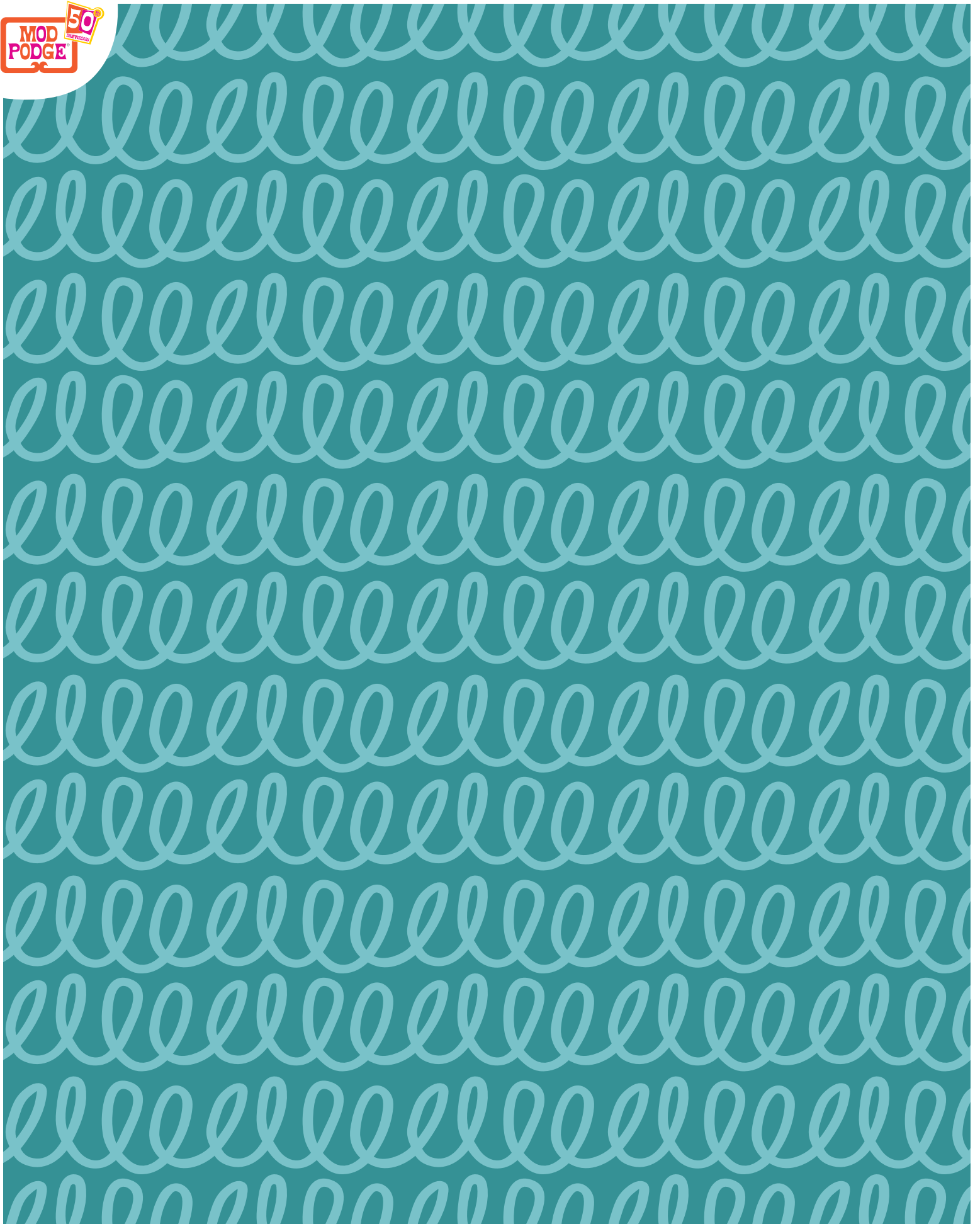

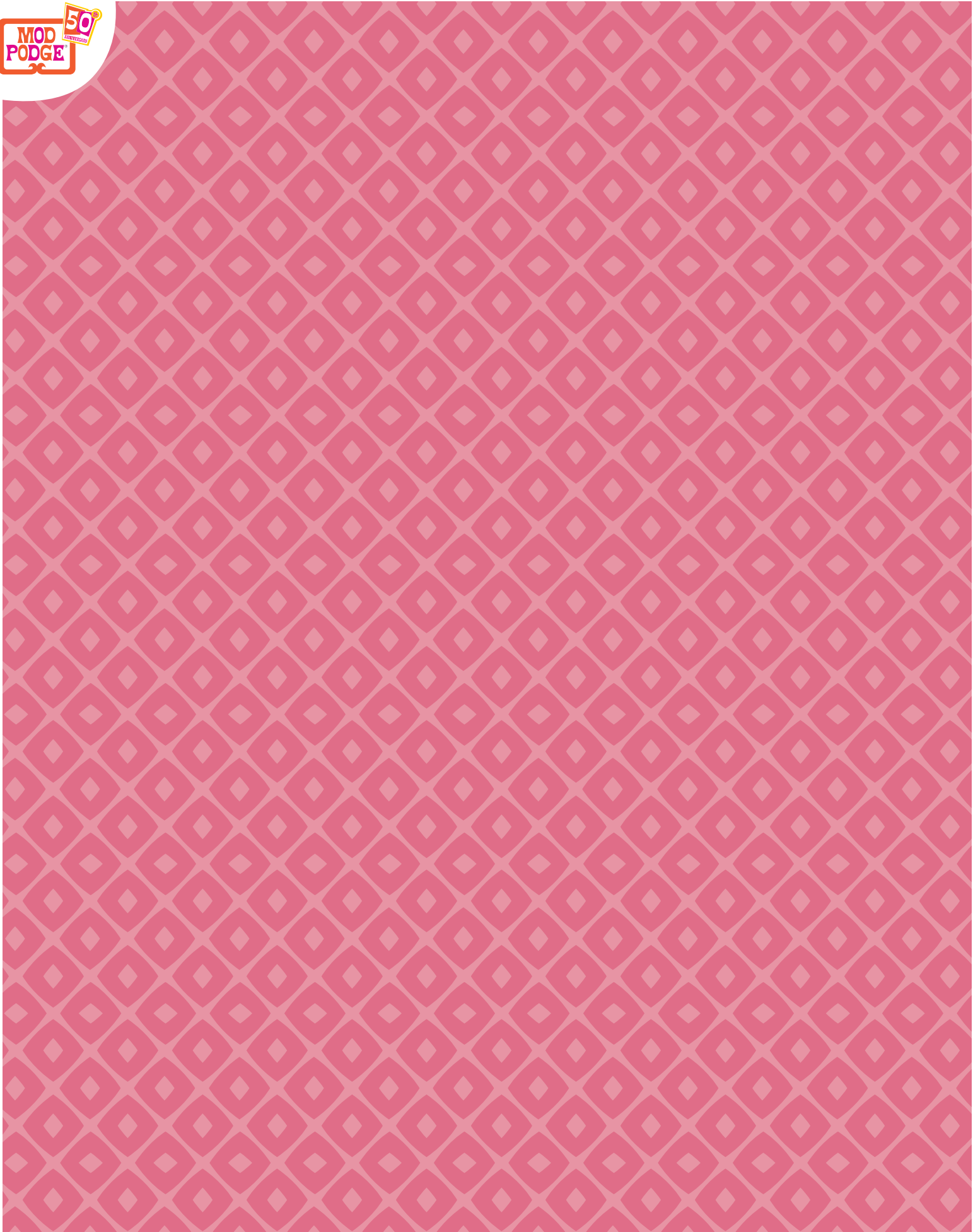

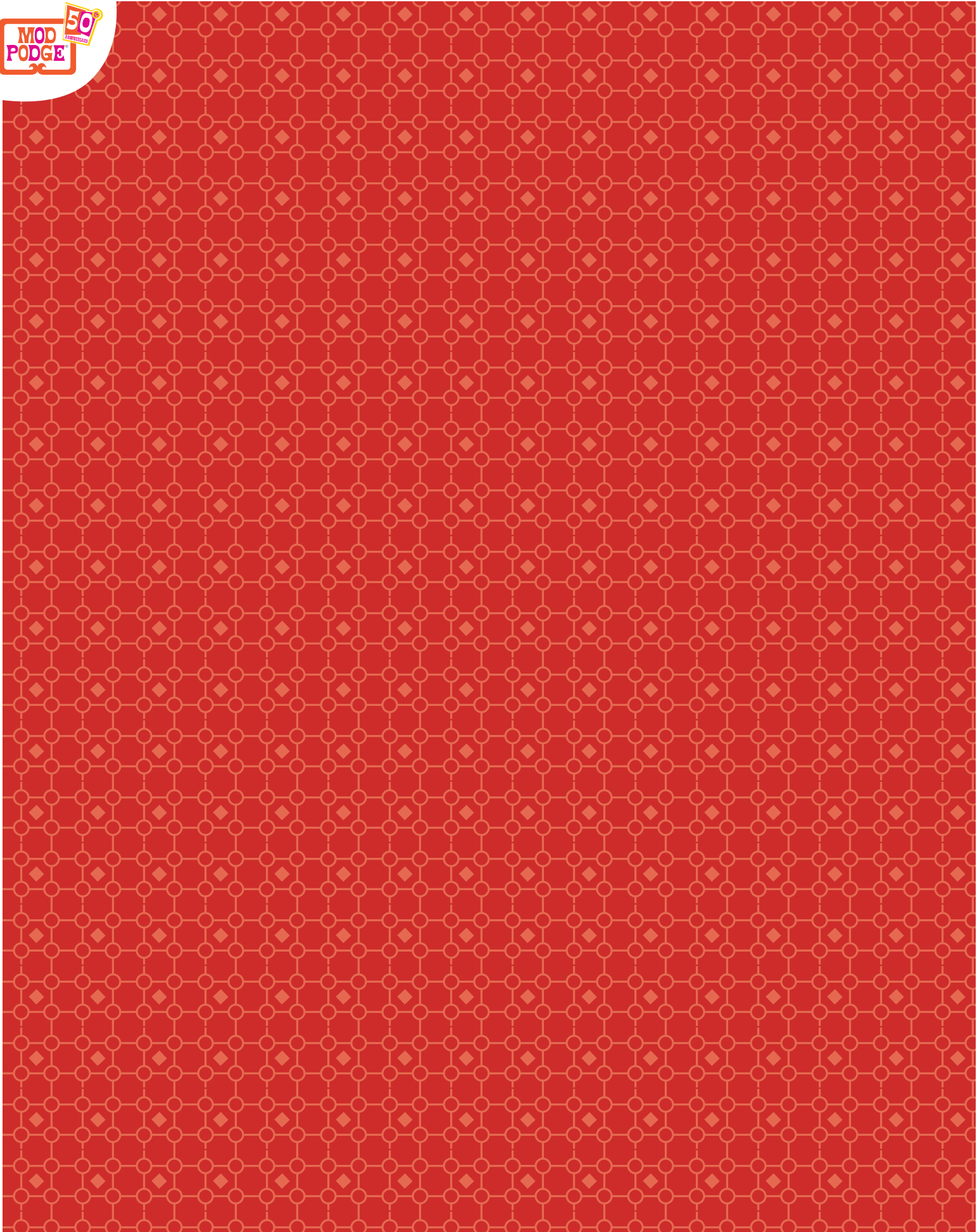

TROPICAL LEAVES

Paper Designer: Kati Sellers
Project Creator: Suzanne Cook

Whether creating to decorate a guest bath, a den, or a vacation home, this Mod Podge Collage Art project is sure to transport you to a peaceful tropical place. Learning the simple trick of coating both sides of the paper with Mod Podge not only adds strength to the paper it also makes it easy to curl paper edges creating a more life-like dimensional effect.

INSTRUCTIONS

Follow the Paper Printing and Preparation Instructions found on page 7. Also, review the Basics of Decouping with Mod Podge found on pages 5-6.

Canvas Prep

Apply a smooth application of Thicket using the FolkArt Basecoating Brush. Allow to dry, then reapply Thicket for opaque coverage. Let dry.

Creating Tropical Paper Leaves

1. Print a full set of patterned papers. Reinsert the printed papers back into the printer, then print a leaf pattern sheet on the backside of every patterned paper.

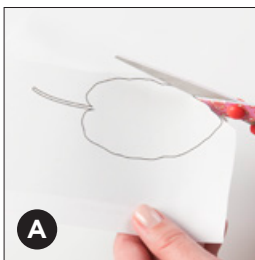

2. With either scissors or a craft knife, cut out one each of the three different leaf patterns with assorted designs. **(Photo A)**
3. Using the Mod Podge Silicone Craft Mat as a work surface, lay each paper leaf, print side down, onto the mat. Apply a coat of Mod Podge Gloss over the backside and allow to dry completely. **(Photo B)**
4. When dry, flip the leaves over and apply Mod Podge Gloss to the patterned side; let dry. **(Photo C) NOTE:** By double coating each leaf, the paper will be stronger yet remain flexible.
5. Next, carefully fold each leaf in half (print sides together), then reopen the fold. Gently manipulate and curve the leaf edges to create depth and realism.

Finishing

Attach the curled leaves to the prepared canvas by applying Mod Podge Gloss to the backside center of each leaf along the stem line. Press in place and allow to dry. **NOTE:** Mod Podge Gloss can also be applied to the leaf edges where they touch the canvas.

TIPS

- Have fun experimenting with both design and color; play around with the placement design of the tropical leaf shapes. Or change up the painted background colors. Perhaps even create a gallery wall and include a few single leaf smaller canvases!
- Each tropical paper leaf can also be attached to the base coated canvas using the Mod Melter and a Clear Mod Melt.

Supply List

Mod Podge Gloss

[Mod Podge FREE Downloadable Papers - Tropical Leaf Collection](#)
(4 different prints and 1 template page)

Mod Podge Seven-Piece Tool Kit

FolkArt Acrylic Colors - Thicket

FolkArt Basecoating Brush Set

8" x 8" Gallery Wrapped Stretched Canvas

Miscellaneous Supplies: Refer to page 4

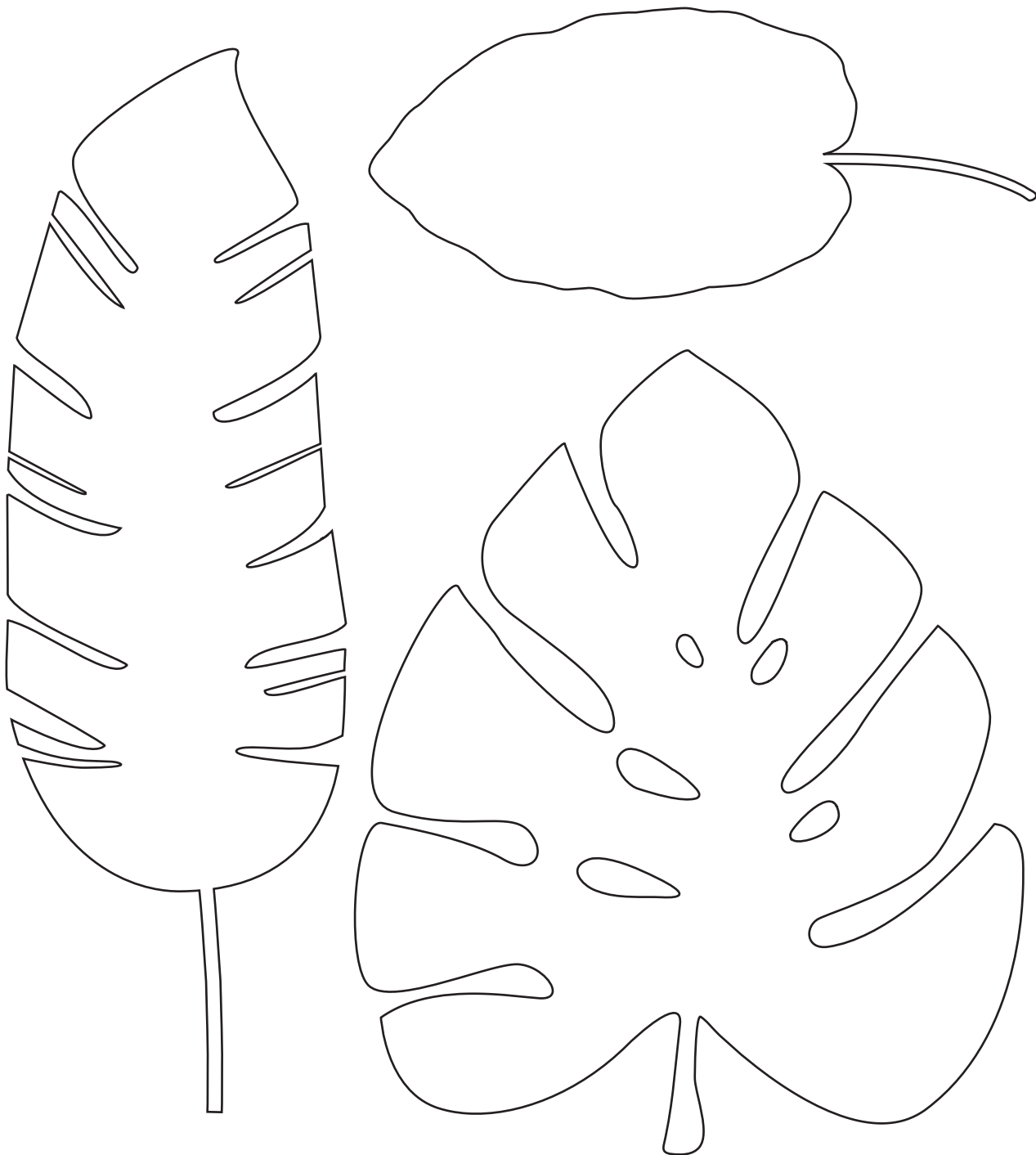

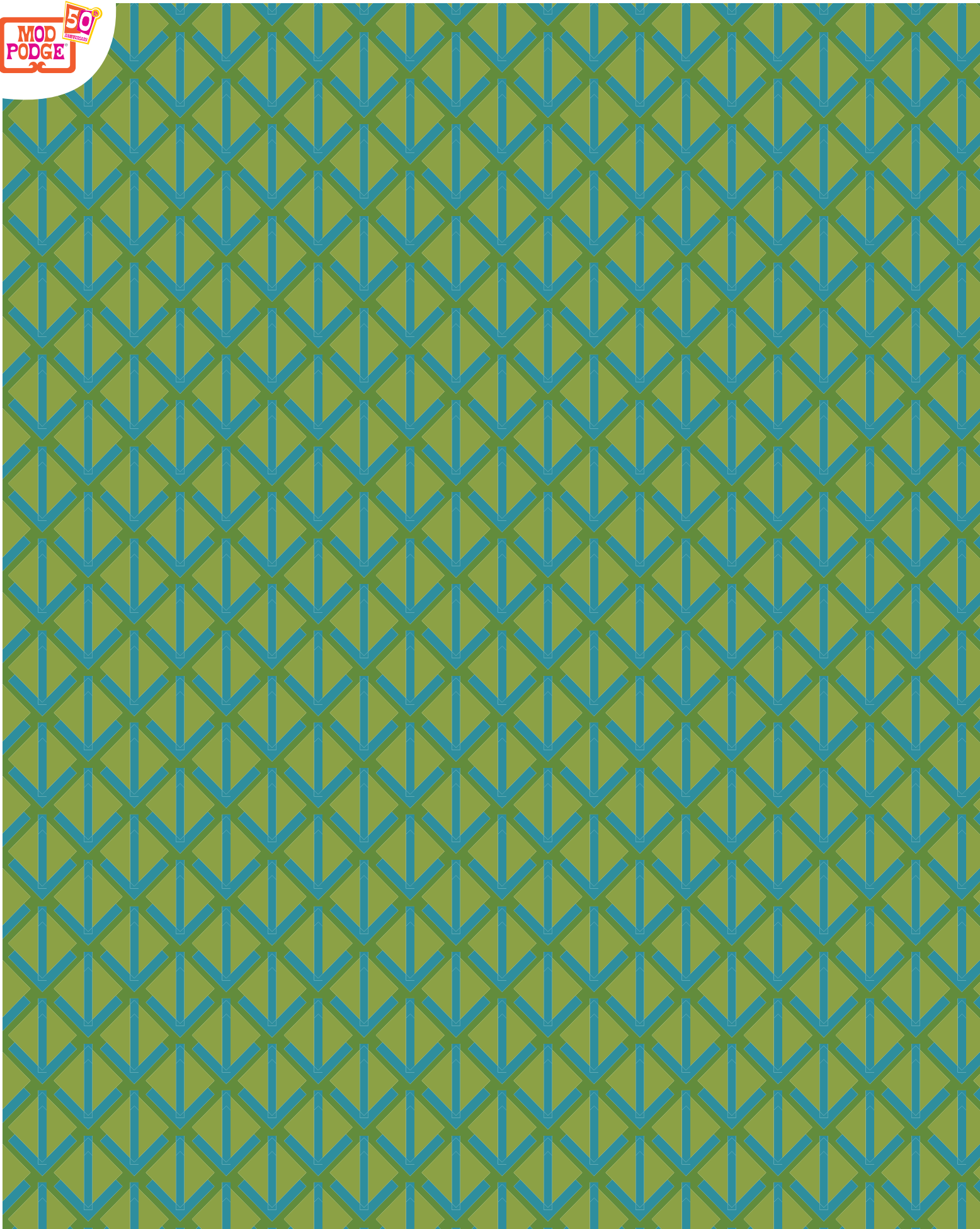





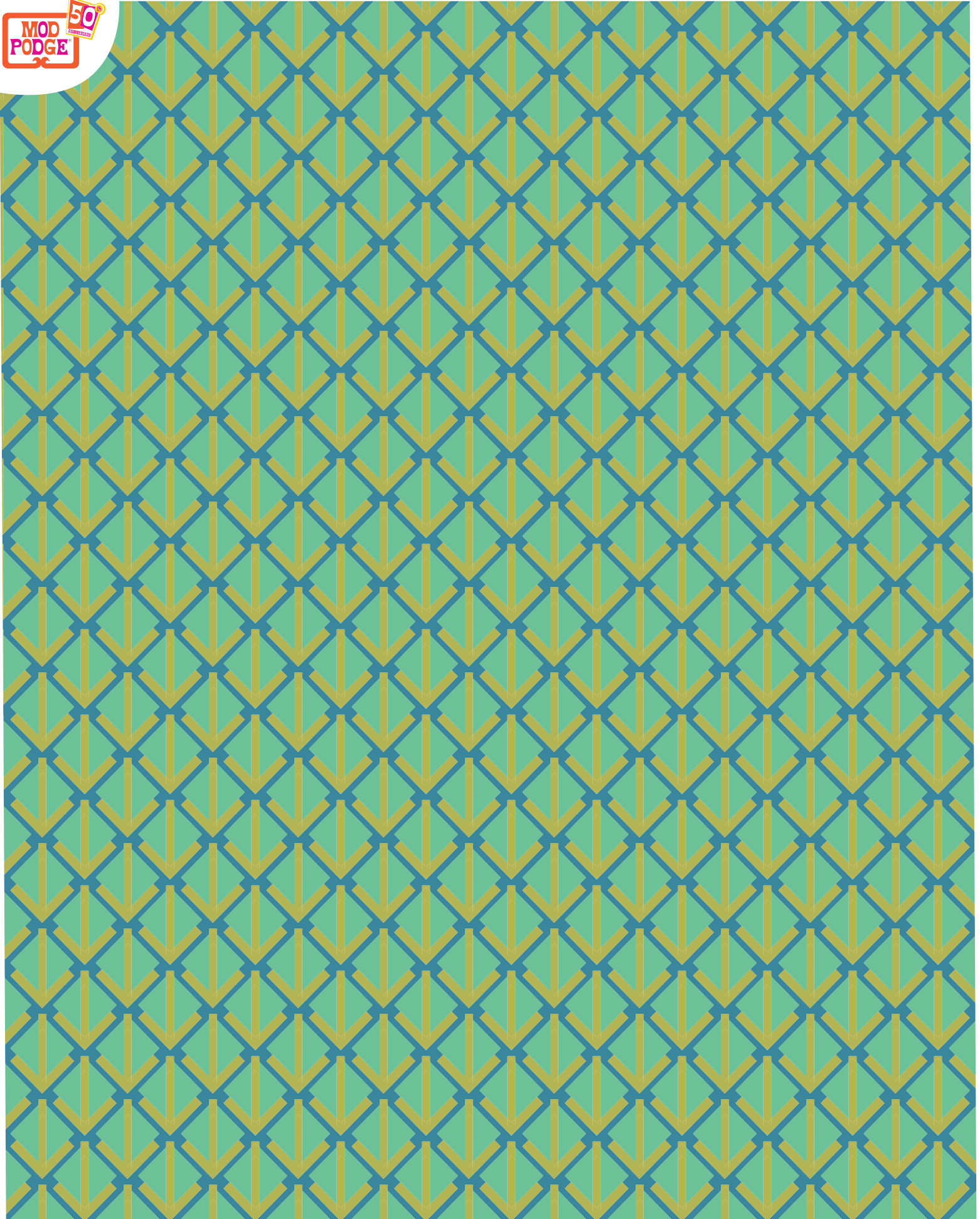

MOD PODGE FORMULA GUIDE CHART

WHICH MOD PODGE SHOULD I USE?

Wood, paper, fabric, glittery, shiny, subtle - WOW! There are so many Mod Podge decoupage possibilities - try them all!

Antique Matte	●	●	●	●		●	●	●	●	●	●	●	●	●	●	●	
Brushstroke Matte & Gloss		●								●	●			●	●		
Classic Matte, Gloss & Satin	●	●	●	●		●	●	●	●	●	●	●	●	●	●	●	
Clear Chalkboard Topcoat		●	●	●		●	●		●	●	●	●	●	●		●	
Dimensional Magic	●	●		●		●	●		●	●	●	●	●	●	●	●	
Dishwasher-Safe			●			●			●								
Extreme Glitter	●	●	●	●		●	●	●	●	●	●	●	●	●	●	●	
Fabric	●	●		●	●		●	●								●	
Furniture Matte, Gloss & Satin	●	●	●	●		●	●	●	●	●		●	●			●	
Glow-in-the-Dark	●	●	●	●		●	●	●	●	●	●	●	●	●	●	●	
Hard Coat	●	●	●	●		●	●	●	●	●	●	●	●	●	●	●	
Outdoor	●	●	●	●		●	●	●	●	●		●	●	●	●	●	
Paper Matte & Gloss	●	●	●	●		●	●	●	●	●	●	●	●	●	●	●	
Pearl	●	●	●	●		●	●	●	●	●	●	●	●	●	●	●	
Photo Transfer		●	●	●		●	●		●	●	●		●			●	
Puzzle Saver															●		
Sparkle	●	●	●	●		●	●	●	●	●	●	●	●	●	●	●	
Stiffy Fabric Stiffener				●				●	●								
Super Gloss Topcoat	●	●	●	●			●	●	●	●	●	●	●	●	●	●	
Ultra Matte Chalk	●	●	●	●		●		●	●	●	●	●	●	●	●	●	
Wash-Out For Kids		●				●			●	●	●				●	●	
		beads, gems	canvas	ceramics	fabrics, cotton	felt	foam	glass	lace trim	leather, suede	metal, tin	paper	paper mache	plaster	plastic, vinyl	puzzles	wood

CONNECT WITH PLAID!

Every day, Plaid reaches tens of thousands of crafters, makers and DIY enthusiasts through all our social media channels.

While visiting Plaid's social channels, you will find creative, innovative projects that will inspire you. You can recreate one of our projects or create an original of your own!

You can also join in our daily conversations across the variety of social media platforms and become a part of the Plaid community. Simply tag your comments and creations #PlaidCrafts.

Won't you join the fun and follow us today? Learn about the new products, try a new crafting technique, and become inspired by viewing our vast offering of easy-to-create artistic projects.



pinterest.com/plaidcrafts



plaidonline.com/blog



plaidonline.com



twitter.com/plaidcrafts



facebook.com/inspiredbyplaid



instagram.com/plaidcrafts



youtube.com/plaidcrafts
<http://bit.ly/MakeltWithModPodge>



plus.google.com/+PlaidOnline



modpodgerocksblog.com



Plaid's Mod Podge Rocks! blog and its creator, Amy Anderson, rock the creative world every day!

- Packed with creative content, phenomenal projects, titillating tips and tidbits
- 2014 Winner for Best Art, Craft or Design Weblog - Bloggies
- Featured on ABCNews.com, Huffington Post, iVillage, and more
- 6.2 million page views in a year, 175 thousand unique visitors each month
- 1.5 million fans/friends/followers

For additional Mod Podge product information, how-to videos and project inspiration, please visit:
<https://plaidonline.com/brands/mod-podge>

To download a FREE copy of "The Ultimate Guide to Mod Podge — Learn the Art of Decoupage"
<https://plaidonline.com/articles/free-decoupage-book-download>

CREATIVE CREDITS Plaid Enterprises Production Team: Category Director, Andrea Henfield; Brand Manager, Connie Lanham; Art Director, Paul LaPlaca; Graphic Designer, Jennifer Byerley; Design Director, Jackie Wynia; Paper Designer, Kati Sellers; Project Creator, Suzanne Cook; Hand Model, Anna Teal; Photography, John Armitage / Bill Skeel; and Education Content Curator, Chris Williams.